

Welcome to

COTTAGE GROVE

2 bedroom, 2 bath Ranch Townhomes

- Convenient North Chili location
- Spacious living room with gas fireplace
- Open kitchen design with breakfast bar
- Master suite with walk in closet
- Easy flowing ranch floorplan (*no steps*)
- Attached 2 car garage with plenty of parking
- Central Air
- Includes washer and dryer
- 24 hour emergency maintenance
- All homes are designed to maximize natural light
- Scenic hillside setting
- Garbage, recycling, and water service included in rent

**1 Cottage Grove Circle
North Chili, NY 14514**

(585) 424-4445



www.CottageGroveTownhome.com



Enjoy the peace & quiet that cannot be found in an apartment

PRIDE MARK HOMES 1501 PITTSFORD-VICTOR RD, STE 200, VICTOR, NY 14564

*Easy Living
Ranch Townhomes*

1,264 square feet with 9' ceilings

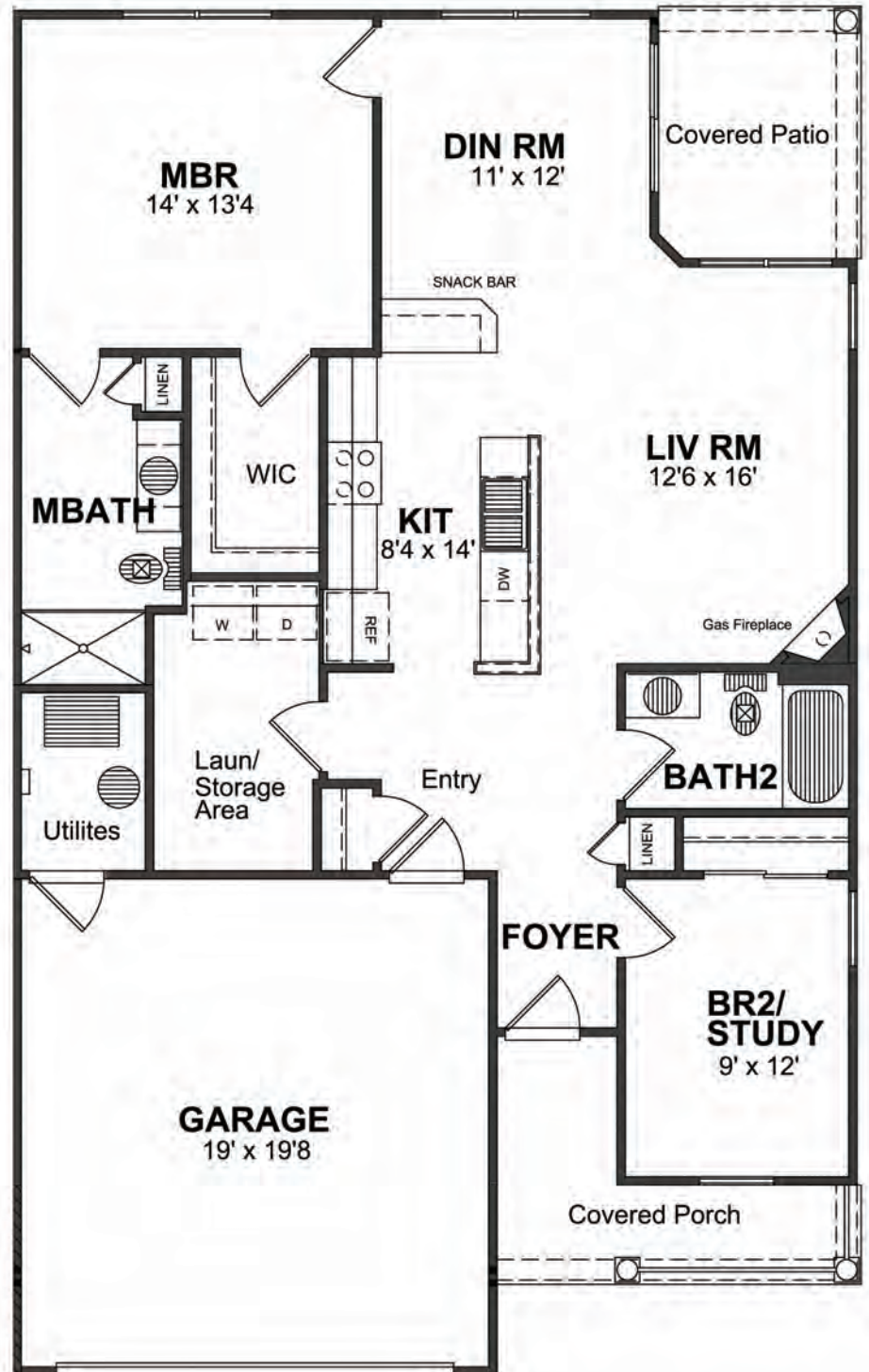



Easy Living Ranch Townhomes



PMhomes.com



Rental Application

The undersigned hereby makes application to lease townhome number _____ building number _____ beginning on _____, at a monthly rental of \$ _____

PLEASE TELL US ABOUT YOURSELF

Full Name _____ Phone () _____
Date of Birth _____ Social Security Number _____
Name of Co-Applicant _____ Social Security Number _____
Number of Dependents (excluding Co-Applicant) _____ Co-Applicant Date of Birth _____
Other Occupants _____

PLEASE GIVE YOUR RESIDENCE HISTORY FOR THE PAST 3 YEARS

Current Address _____
Month & Year Moved In _____ Reason for Leaving _____
Owner/Agent _____ Phone () _____ Fax () _____

Previous Address (if within 3 years) _____
Month & Year Moved In _____ Reason for Leaving _____
Owner/Agent _____ Phone () _____ Fax () _____

PLEASE GIVE YOUR EMPLOYMENT INFORMATION

Your Status: Employed Full-Time Employed Part-Time Student Retired Unemployed

Employer _____ Employed As _____
Address _____
Supervisor _____ Supervisor's Phone () _____ Fax () _____
Salary _____ per _____

Previous Employer _____

If there are other sources of income you would like us to consider, please list income, source and person.

Amount \$ _____ Source _____
Amount \$ _____ Source _____

PLEASE LIST YOUR BANK AND CREDIT REFERENCES

	Your Bank(s)	City/State	Branch	Type of Account
1.	_____	_____	_____	_____
2.	_____	_____	_____	_____

Your Driver's License Number _____ State _____
Your Vehicle Make/Model _____ Year _____ Plate No. _____ State _____
Second Vehicle Make/Model _____ Year _____ Plate No. _____ State _____

CONTACT IN CASE OF EMERGENCY

Name _____ Phone () _____

HAVE YOU EVER: Been convicted of any crimes? Yes No

 If yes, please explain _____

How did you hear about Cottage Grove? _____

If Cottage Grove has any question regarding this application please give phone numbers where you can be located

Day Phone _____ **Night Phone** _____

E-mail address: _____

PLEASE TELL US ABOUT YOUR PET

Check here if you wish to have a pet

Type of Pet Dog Cat Other _____

Size _____ lbs. Age _____ Color _____

Breed of Pet _____ Name of Pet _____ License Number _____

A copy of your pet's license and a photograph must be provided with the Rental Application

Within five (5) days after receipt of notice that this application has been processed and accepted, I shall execute the lease and make the lease security deposit. The amount of the lease security deposit will be one month's rent.

By signing this application, the applicant affirms that all of the information in the credit application is true and complete, whether completed by the applicant or by the landlord at the direction of the applicant. The applicant makes the above representation knowing that the landlord is relying on the information and that if any of the information is discovered to be false, landlord at its option may cancel and annul any lease given in reliance upon the information. If this application is approved, this application shall be incorporated by reference and made a part of this Lease.

Signature on this application authorizes the Landlord to obtain (1) a consumer report (credit history) from a consumer reporting agency in considering this application; (2) employment verification; and (3) Landlord verification. Signature on this application authorizes the Landlord to obtain credit information from other sources and may exchange record regarding credit experience with consumer reporting agencies. Should the applicant request, the application will be informed whether or not a consumer report was requested, and if such report was requested, the name and address of the consumer reporting agency that furnished the report.

The acceptance of this application and/or a deposit does not constitute approval of this application or an agreement to lease.

Signature of Applicant _____ **Date Signed** _____

Signature of Co-Applicant _____ **Date Signed** _____